

# AZURA

*Aspendale*

Another quality project by

**LOWE** | LIVING



# Coastal Living Redefined

Showcasing coastal sophistication and exquisite architectural design in a tranquil beachfront setting, Azura is inspired by the Spanish name meaning 'sky blue' and presents a sanctuary of style with a strong connection to its elite location. Four boutique buildings are interconnected, cultivating a sense of community and offering supreme privacy, security and direct beach access.

The relaxed ambiance of a flowing indoor and outdoor lifestyle is from a collaboration between the acclaimed Lowe Living and award-winning design partners, Chamberlain Architects, Golden and Jack Merlo. With a combination of 8 townhomes and 19 apartments, including '*The Beachfront Collection*' of 10 beach-facing residences, Azura Aspendale has redefined coastal living.



## ARCHITECTURE

# *Created for the coastal lifestyle*

A complementary blend of light, materials and texture result in an uncomplicated synergy between the inside and out. Designed to sit in harmony with its beachside environment, Azura effortlessly integrates with the surrounding landscape. Situated on Foster Street, a tranquil cul-de-sac location provides the perfect setting to enhance the calm atmosphere of coastal living.



External Façade – Foster Street



PROJECT ARCHITECT

# Chamberlain Architects

A design focused architecture practice with a fundamental interest in collaboration, Chamberlain Architects craft residential dwellings to enrich and enhance people’s daily lives. They are committed to creating well-planned, functional and sustainable solutions by exploring the relationship between light, space and materiality.

—

Chamberlain Architects is recognised for their commitment to the fundamentals of good space planning and sustainable solutions. How has this been reflected in Azura’s design?

As a practice we’re interested in how light, space and material can be woven through every project. At Azura we focused on opening air circulation to each building via the interconnected open-air walkways, creating better opportunities for light, ventilation and to make the most of the sea breeze. The site planning capitalises on the ocean views, whilst also sensitively dealing with immediate neighbours by setting back and providing landscape buffers. We also integrated expansive private roof terraces for select beach-facing apartments, showcasing uninterrupted views, as well as providing the option to integrate rooftop terraces into most of the townhome designs, should the resident request.

The design for the project is quite unique. What elements would you say are the key standout features in the design?

First and foremost, the uninterrupted ocean views available to ‘The Beachfront Collection’ beach-facing apartments. We also feel there is a strong connection between the entire development and the beach and privacy, which was important to Lowe Living when conceptualising the project.

What inspired your design for Azura and how do you feel this complements the location and community of Aspendale?

Drawing from tropical modernism examples in Brazil and examples from tropical parts of Asia, we landed on a material palette of concrete, red brick and timber. These precedents also inspired the informed scattered brick components of the design and horizontal concrete render framing facing the beach. Azura is also quite unique, in that it has very little impact on the streetscape and is largely hidden, creating a private sanctuary for residents, nestled beside the beach.

As a practice, Chamberlain Architects places a big focus on using architecture to create ease in people’s lives. How does Azura’s design add to the day-to-day life of the future resident?

We create our residential architecture to support peoples’ daily habits, looking for ways to support these within our design. Azura will feel quite removed from the outside world and we imagined it to be a place to retreat to every day. Whilst largely removed from the street frontage, there are pedestrian walkways that connect Azura to the street, allowing residents to easily walk to the nearby shops and train station, but also, primarily providing direct and private access to Aspendale Beach.

“Given the beachside location, we looked towards tropical architectural precedents for inspiration, with the intention to give the development a resort-like feel. Driven by the desire to create a strong connection to the beach, a central walkway traverses the site which provides every residence an easy and direct path. Wide setbacks between dwellings and significant courtyards within the apartment building provides each residence with a generously sized and private open space, as well as good access to daylight and cross ventilation.”

Glen Chamberlain, Director  
Chamberlain Architects

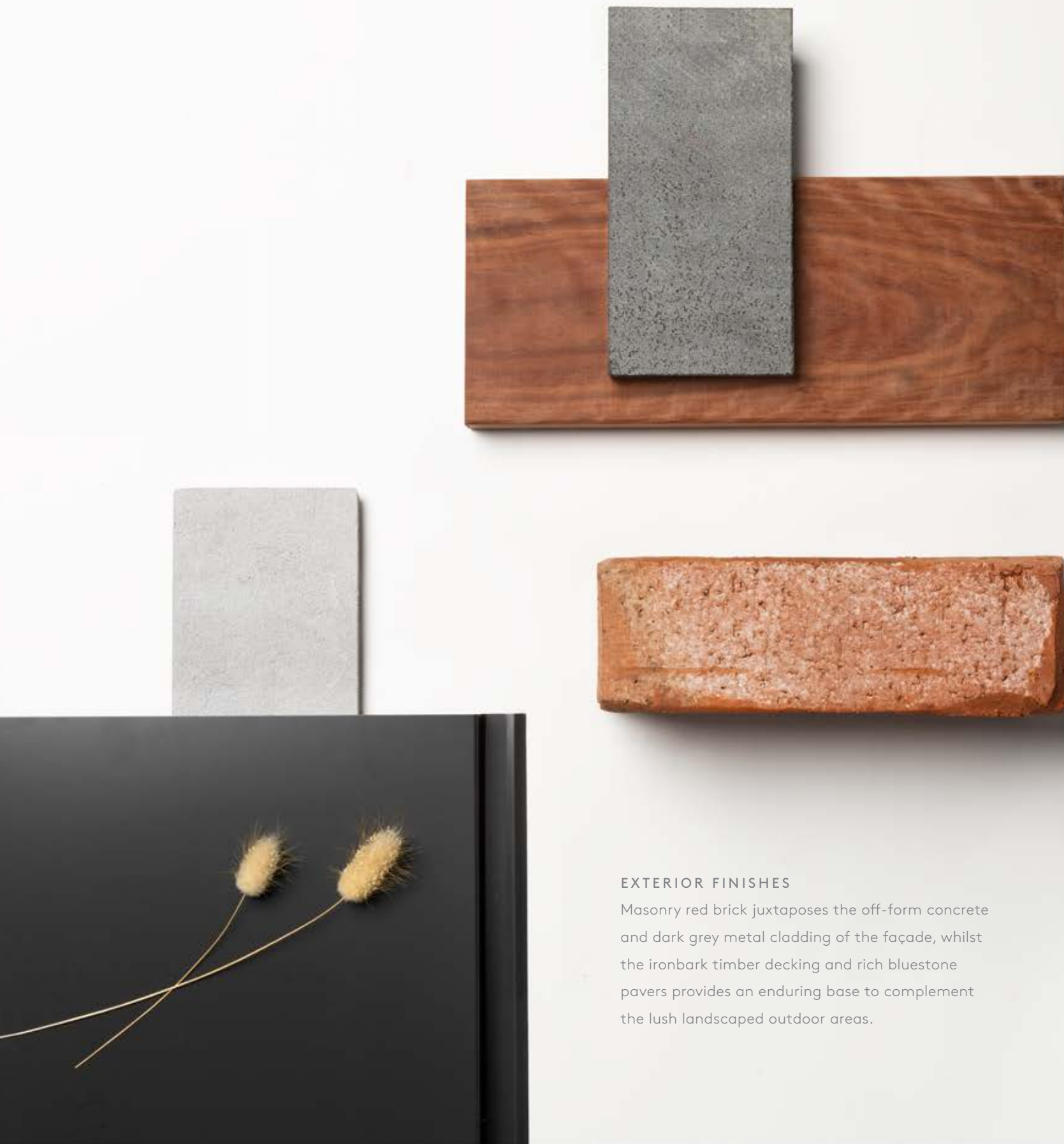

EXTERIOR FINISHES

Masonry red brick juxtaposes the off-form concrete and dark grey metal cladding of the façade, whilst the ironbark timber decking and rich bluestone pavers provides an enduring base to complement the lush landscaped outdoor areas.







# *A sense of address and arrival*

Enveloped by lush native plantings, renowned landscape architect, Jack Merlo, has given great consideration to the coastal location, using feature foliage and greenery to cohesively link the landscape and architecture. Apartments and townhomes are provided with separate entryways, whilst a sense of community is established through interconnecting walkways leading directly to the beach. Additional amenities include secure basement parking for all residences, with private garages available to all three-bedroom apartments and townhomes.

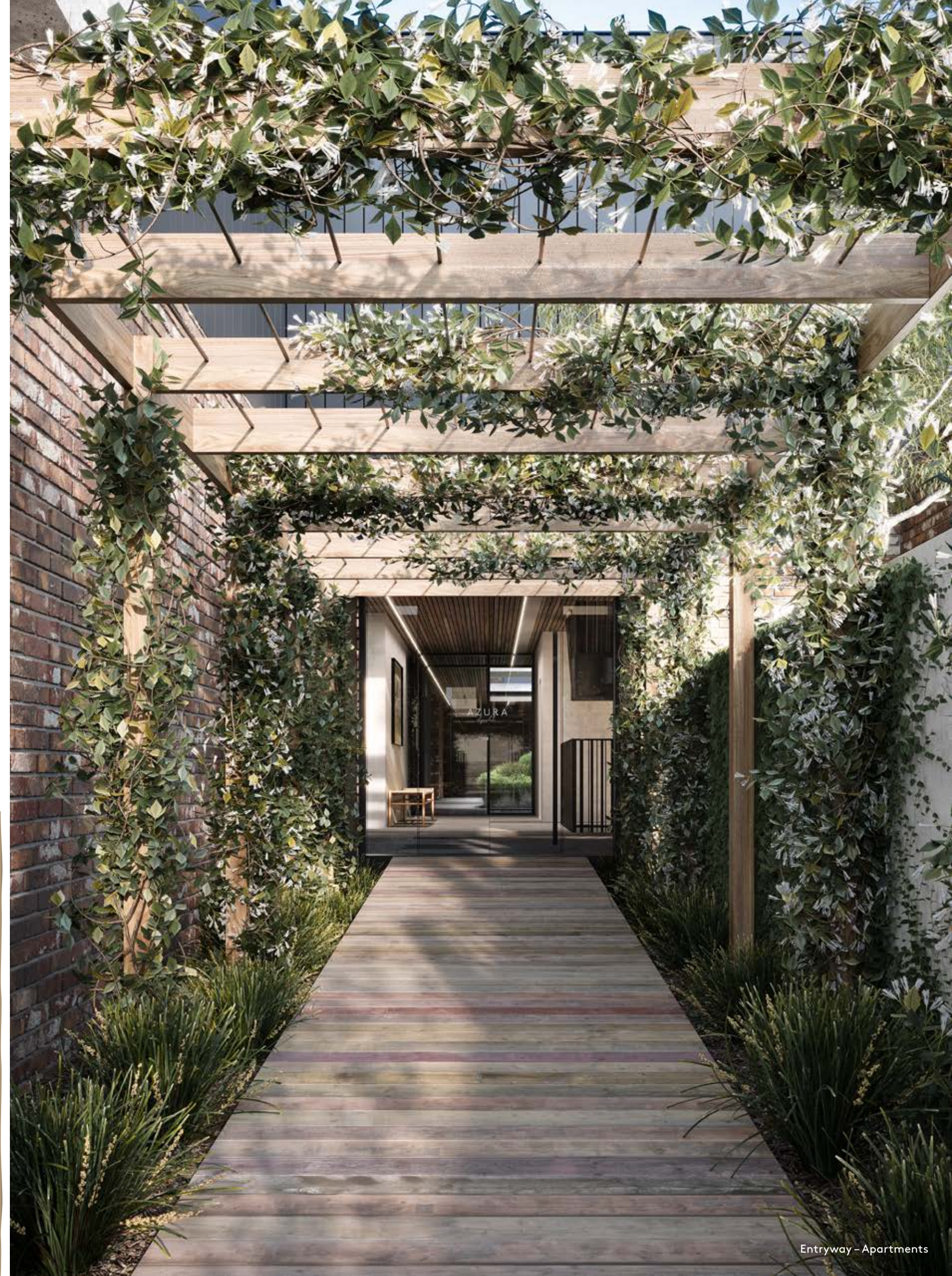

Entryway - Apartments





## *Sculptured form*

Azura's exclusive collection of 8 townhomes sit comfortably within two buildings, each with a distinctive façade displaying a unique two-level architectural design inspired by its beachside location. Showcasing motifs of linearity, vertical lines are complemented by horizontal edgings that draw a simple yet discernibly sculpted form against the natural backdrop. Private gated entryways connect each townhome to Azura's communal walkway leading out to the beach, whilst Jack Merlo's landscape design enhances a sense of privacy and security.



# *An absolute beachfront position*

The communal walkway embraces a simple yet sophisticated aesthetic, offering private and direct beach access. Encapsulating the essence of a coastal lifestyle, morning walks along the white sandy dunes of Aspendale Beach and paddle boarding on the calm crystal blue waters will become a daily ritual.

Cultivating an environment of natural beauty, breathtaking views are emphasised by Azura's absolute beachfront position, celebrating every opportunity for all residences to take in the natural beachside landscape. Whilst all beach-facing apartments enjoy uninterrupted views of Aspendale Beach and Port Phillip Bay, a select few enjoy private rooftop terraces.

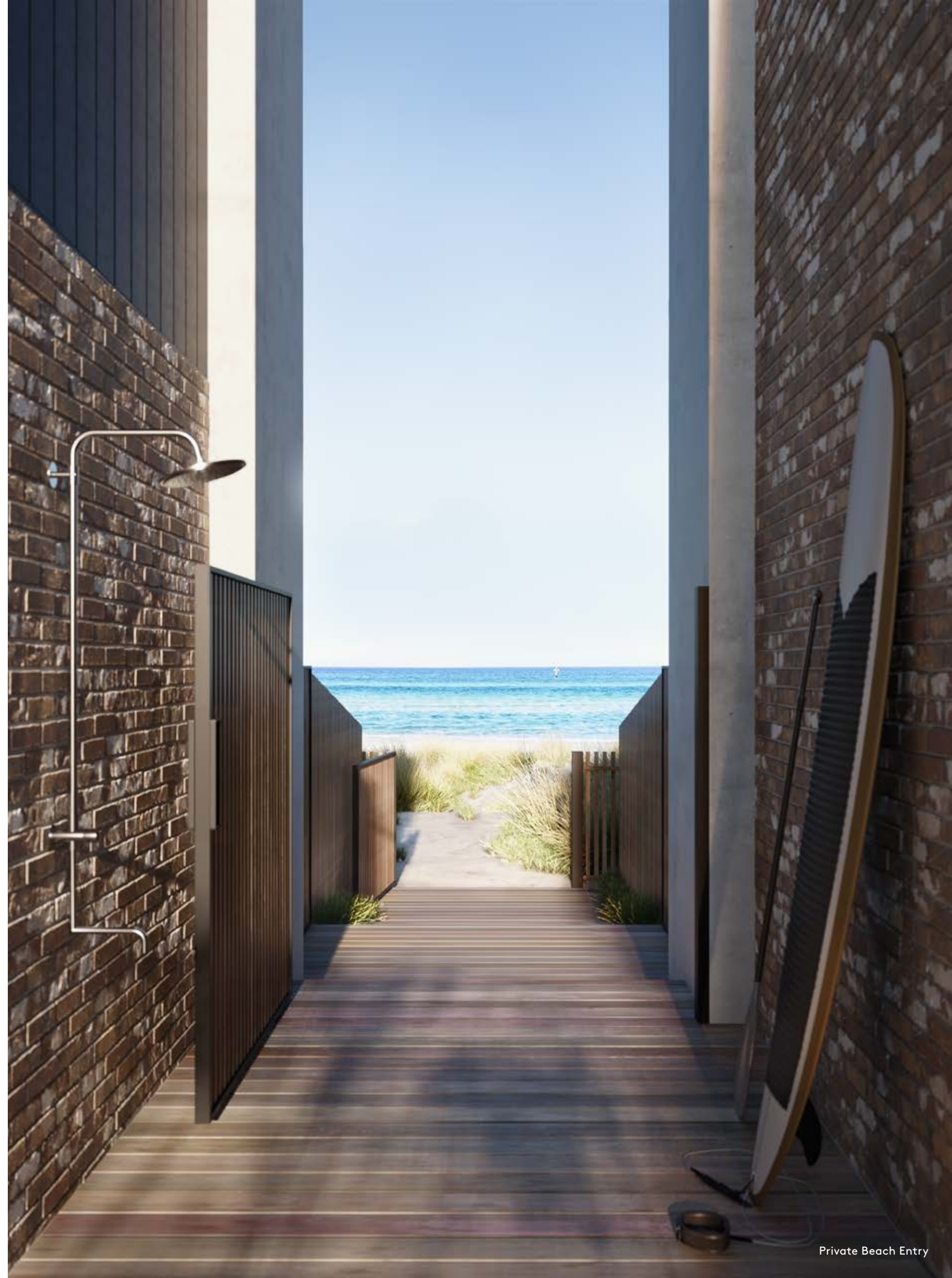

Private Beach Entry







## INTERIORS

# Blissful interior spaces

A thoughtful use of light and space allows for private moments of bliss, where internal spaces unite with the outside world. A place to retreat and relax in the peaceful surrounds, Azura has been sensitively crafted with a focus on high-end living that draws inspiration from its coastal location.





# From concept to creation

The vision for Azura's interiors were conceptualised through a collaborative partnership between Golden and Lowe Living.

Every aspect of the development has been carefully considered by Golden and Lowe Living to deliver high-end living in a world-class location. Artistic impressions were workshoped to allow refinement of the finishes palette and overall feel of the residences. By drawing inspiration from the absolute beachfront setting, Azura's design is uniquely refined and effortlessly elegant.

*"The interior design of Azura is inspired by its location. Demonstrating a sophistication to the aesthetic with an unbuttoned sensibility and association to the tranquility of the beach. The 'house-like' dwellings drove our design ethos, with the function of spaces feeling less apartment and more home style. The finishes palette is neutral presenting a canvas that allows the residents furniture and art collections be complemented rather than secondary."*

Alicia McKimm, Director  
Golden





PROJECT INTERIOR ARCHITECT

Golden

A desire to contribute to a better quality of life underpins Golden’s interior design principles. Elevating interior spaces to expressions of modern life, Golden’s work is firmly focused on creating intelligent interior spaces drawing from the rich beauty of the natural landscape.

Golden has described the interior design of Azura as timeless, coastal and luxurious. Can you tell us more about what inspired your design?

The interior design of Azura is inspired by its location, a sophistication to the aesthetic with an unbuttoned sensibility and an association to the tranquility of the beach. ‘House-like’ dwellings drove our design ethos, ensuring the function of spaces felt less apartment and more home-like. We wanted to keep the finishes palette very neutral and fitting to the coastal location, presenting a canvas that allows the resident’s furniture to be complemented rather than secondary. Ease of maintenance is supported by the finishes, which are hardy and enduring to accommodate day-to-day living demands. The residences definitely appeal to a discerning character who understands quality design.

The collaboration between Chamberlain Architects and Golden has achieved a seamless and complementary partnership between the internal and external architecture. How do you feel the interiors respond to the architecture?

Azura’s access zones from the beach and open-air walkways are transitioned by either external courtyards or gate-to-front door alcoves. Golden in collaboration with Chamberlain Architects, aligned our finishes palette for a seamless passage from external to internal spaces. The interiors also present larger than average living and dining areas, bedrooms, bathrooms, kitchens with ample storage and preparation areas, as well as kitchen sculleries where possible.

Golden mentions that the coastal location has influenced several elements of the interior design, as well as promoting quality. What are the key standouts in your design?

Influenced by the coast, the custom designed fireplace featured in ‘The Beachfront Collection’ is clad with large format chalky limestone and a TV unit surfaced with hand-made ceramic tiles, almost shell-like. Quality materials including engineered boards, man-made veneers, premium appliances and fixtures, such as Miele and Phoenix Tapware, can be attributed to a durable aesthetic, all in line with our spirit of design which is timeless and long-lasting. Granite benchtops, also featured in ‘The Beachfront Collection’, and available to all residents, is brushed and flamed purposefully to present a soft texture, as well as the inclusion of a Lumil pendant over the island bench for additional preparation lighting.

Golden is known for demonstrating an intuitive understanding of how physical environments impact our wellbeing. Sustainability was mentioned as a key driver behind your design ethos, are you able explain this further?

Azura is graced with bayside breezes and the site plan encourages cross-ventilation and natural airflow. Complementing this internally, best practice has been employed with sustainability and all appliances are star rated, with thermal materials aiding in insulation including engineered timber floorboards and acoustic underlay to carpets.

INTERIOR FINISHES

Inspired by the coastal surrounds, light timber tones feature across engineered timber floorboards and timber veneer laminate in kitchens. Light grey Caesarstone benchtops are paired with soft grey 2Pac to kitchens and natural white 2Pac to bathrooms. Accents of brushed brass and vibrant green ceramic feature tiles perfectly complement bathrooms of white porcelain wall tiles and sand inspired porcelain floor tiles. While soft golden tones feature in natural wool carpet to bedrooms.

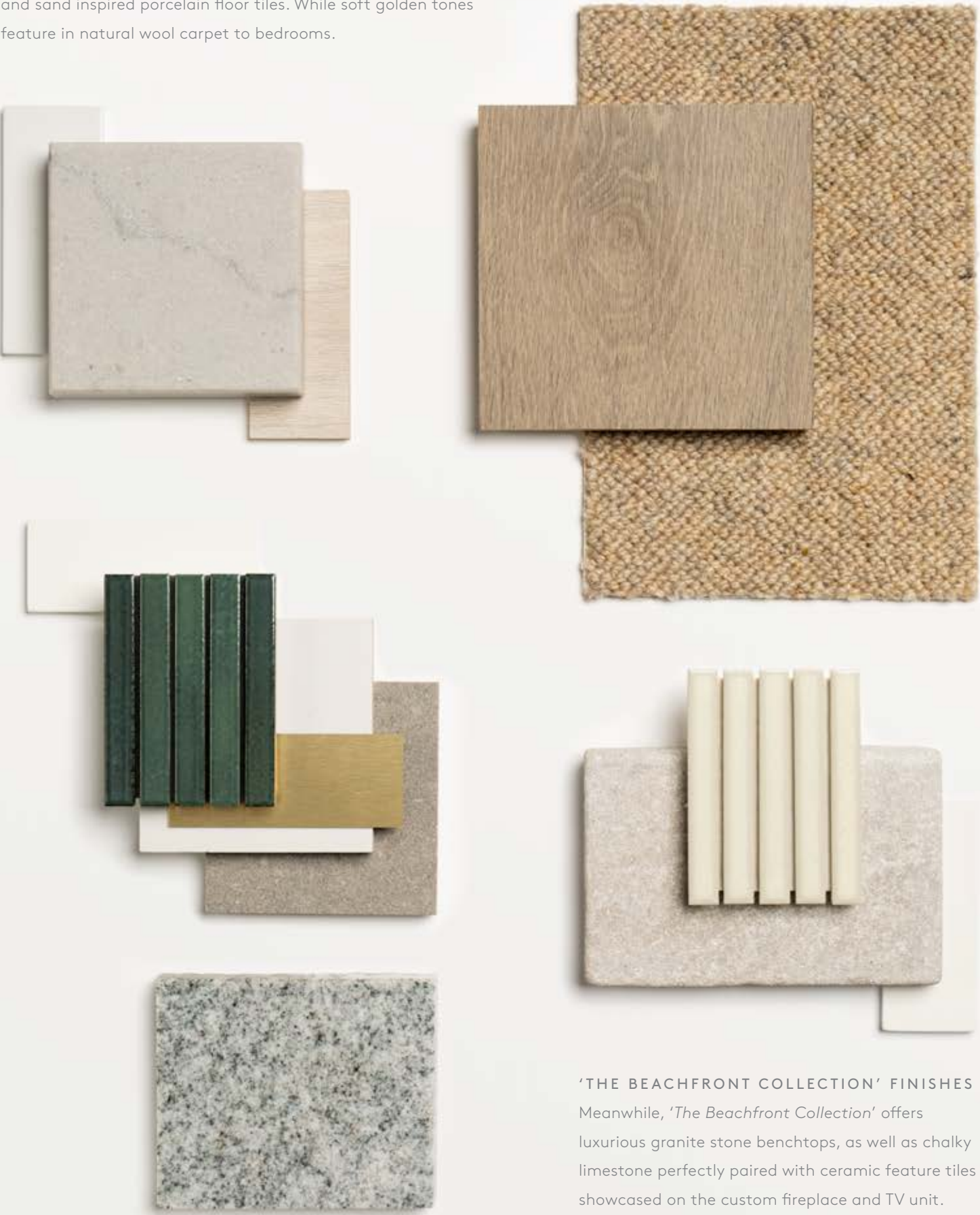

‘THE BEACHFRONT COLLECTION’ FINISHES  
Meanwhile, ‘The Beachfront Collection’ offers luxurious granite stone benchtops, as well as chalky limestone perfectly paired with ceramic feature tiles showcased on the custom fireplace and TV unit.





Living - 'The Beachfront Collection'

## Boundless spaces

'The Beachfront Collection' comprises of 10 beach-facing apartments commanding uninterrupted views of Aspendale Beach and Port Phillip Bay. Expansive open-plan living areas feature a custom designed fireplace and TV unit, also available as an upgrade for non-beach-facing apartments and townhomes.

Full height windows and sliding doors promote natural light and maximise airflow in open-plan living and dining areas throughout Azura, boasting durable engineered timber floorboards and double-glazing to windows.





## *An ocean backdrop*

Breathtaking in beauty, spectacular in scale and uncompromised in quality, Azura focuses on bringing moments of joy and delight to daily living. Interiors showcase elements influenced by the dramatic panorama, with carefully considered floorplans allowing for vast open spaces that promote open-plan living and connection with the outdoors. Watch the sun set over the glistening bay and enjoy meals with a sensational backdrop.



# Illuminated luxury

Cohesively linking the landscape and architecture, glorious outdoor spaces incorporate balconies, courtyards and rooftop terraces designed to celebrate open vast spaces, promote air circulation from the sea breeze and provide the perfect place to retreat. *'The Beachfront Collection'* capitalises on Azura's absolute beachfront location with uninterrupted bay views, while non-beach-facing residences still enjoy private and direct beach access via the communal walkway.



Balcony - *'The Beachfront Collection'*





Kitchen – *'The Beachfront Collection'*

## Unparalleled style

A considered layout featuring stone benchtops, strategic lighting and thoughtful storage solutions to maximise practicality, defines the ultra-stylish kitchens throughout Azura. Finished to the highest standard, kitchens feature streamlined fully integrated fridges, as well as quality Miele wall ovens, gas cooktops and dishwashers. Brushed nickel fixtures from Phoenix Tapware also showcase throughout.

Select residences boast spacious butler's pantries, while kitchens in *'The Beachfront Collection'* maximise on the ocean views and are appointed with granite benchtops and a custom designed Lumil feature light over the island bench, as well as additional appliances including a steam oven and wine fridge featured within the bar unit.





Master Bedroom

## *The height of elegance*

Merging pure, simple and minimalist design choices, the opulent master bedroom suite is a place for restful relaxation. Expanses of glass highlight the meticulous attention to detail and create open and airy spaces. Appointed with plush wool carpet, the neutral palette presents as a canvas allowing residents to personalise with their own furniture and art collections.



# Perfectly peaceful

Bathrooms are sleek, stylish and fitted with premium finishes and fixtures including beautiful stone benchtops, brushed nickel tapware from Phoenix Tapware, porcelain floor and wall tiles, as well as vibrant green feature ceramic wall tiles and accents of brushed brass.

Refreshingly contemporary, yet timeless and classic, master ensuites are crafted for comfort and thoughtfully designed for ease of living. A minimal design creates an orderly space, complemented by luxurious details including walk-in showers, double mirrored vanities, a wall mounted feature light and plenty of storage. Master ensuites in three-bedroom residences also boast twin showers with a rain and hand-held shower head, as well as concealed cisterns to toilets.









PROJECT LANDSCAPE ARCHITECT

Jack Merlo

One of Australia’s leading landscape architects, Jack Merlo takes pride in bringing a unique architectural approach to landscape design. Creating spaces people will appreciate for years to come, each project is a considered response to the vision of his client, bringing an ordered and organic form to the built environment.

The absolute beachfront location of Azura is described as one of the key influences of your landscape design. How has this inspired the design of the private and communal spaces, and how do you feel the landscape design complements the Aspendale community?

Our design evokes a coastal feel of the broader suburb, as well as the waterfront location. There is structure to the planting, with mass planting of native grasses and shrubs creating a relaxed feel. We considered the conditions being front-line coastal and made sure the landscaping was able to respond appropriately. For the perimeter we have used species indigenous to the area, as they fit visually and have been tried and tested. Landscaping of the communal walkway has substance, with small to medium scale trees. This leads you visually and physically through to the foreshore beyond, capturing the amazing view through to the ocean.

The future resident has been considered in your design, with regards to both convenience and maintenance. How have you translated this into the landscaping?

We were inspired by the future occupants and considered who these might be. Potentially moving out of houses with larger gardens and looking for a functional outdoor space requiring less maintenance, or someone looking to relocate to a beachside location. Large living spaces are bathed in natural light and open to outdoor areas featuring natural timbers and stone, that are consistent throughout the architecture internally and externally. These areas require minimal maintenance, so residents can enjoy the garden instead of tending to it.

Your landscape design responds to the overall architecture, with privacy and security both prominent throughout. What are the key standouts in your design?

Having a mix of townhomes and apartments, Ground Floor gardens and First Floor terraces respond to the space available. We aimed to create a sense of privacy, softness and enclosure, using both physical screens and planting. Planters also feature as bench seats to utilise the area and encourage you to immerse yourself in the space. There is a cohesion between the landscape and architecture, not only in the use of materials but also the flow of the spaces. For the townhomes, their primary outdoor spaces have a Northern orientation. They feature substantial spaces that extend directly off living areas, creating a landscaped green leafy backdrop. Whereas the beach-facing apartments are all about the view, featuring low-level landscaping to maximise on this. Non-beach-facing apartment courtyards include timber decking to reference the beach interface, creating a softer appearance visually and also underfoot, given they have a Westerly aspect that catches a lot of afternoon sun.

Jack Merlo is known for creating spaces that people will appreciate for years to come. How has sustainability been reflected in your design?

We have worked closely with Chamberlain Architects to ensure areas are highly detailed but also well resolved, using quality materials. Local and indigenous species with low water requirements speak to the sustainability of the landscaping and allow maintenance to stay to a minimum, maximising convenience for future residents.

*“We place a big emphasis on ensuring outdoor spaces are usable, highly functional and an extension of the internal living space. It’s important that outdoor spaces function correctly and are both inviting but maintain their visual appeal. Local and indigenous species feature in the design, offering sustainable landscaping and allow outdoor areas to remain presentable for Azura residents all year round.”*

Jack Merlo, Director  
Jack Merlo



LANDSCAPE SPECIES  
Drought and frost tolerant Dwarf Bottle Brush and Dwarf Snow Gum are found throughout, providing shade and privacy. The White Happy Wanderer Vine climbs tall over communal entryways, providing greenery overhead. Meanwhile, the Dwarf Weeping Wattle’s compact form lies low and softens garden beds.





Living & Outdoor – Townhome

## Harmonious transition

A seamless transition between indoor and outdoor spaces creates the ultimate area for year-round entertaining. Full height windows and sliding doors enhance the continuous flow between open-plan living and outdoor zones, allowing for an abundance of natural light, while framing the exceptional views of the surrounding nature. Landscape architect, Jack Merlo, employs native plantings that tie in with the surrounding environment and provides supreme privacy and security.

Azura's neutral tones and natural consistencies present in harmony with its beachside surrounds. Highly detailed yet simple, the landscape design promotes low maintenance spaces using premium materials such as timber, bluestone and sustainable landscaping. Whilst beach-facing apartment G.01, enjoys an in-ground pool with the ocean forming part of its stunning backdrop.







LIFESTYLE & LOCATION

*Beachside luxury  
with lifestyle convenience*





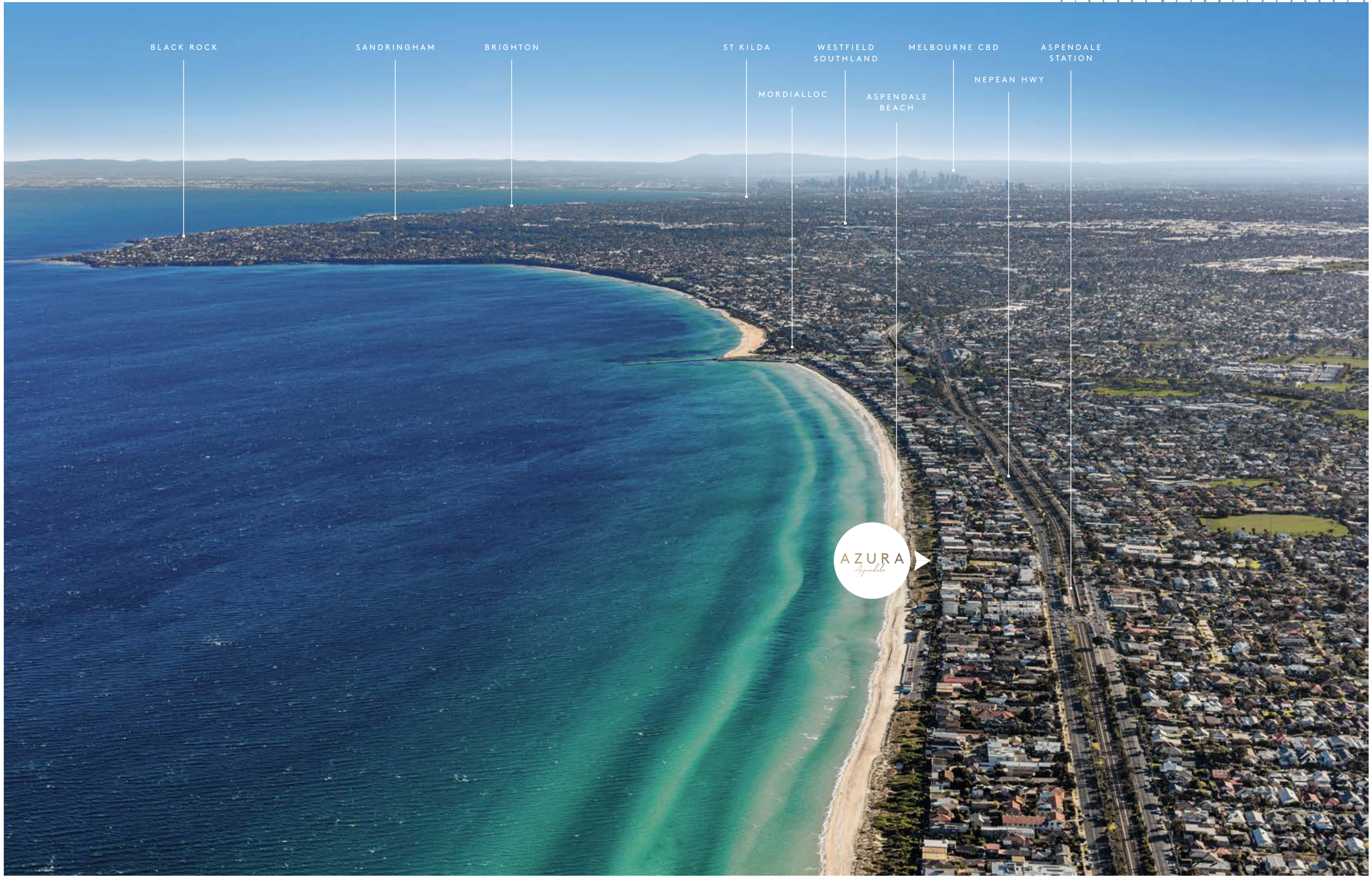

BLACK ROCK

SANDRINGHAM

BRIGHTON

ST KILDA

WESTFIELD  
SOUTHLAND

MELBOURNE CBD

ASPENDALE  
STATION

MORDIALLOC

ASPENDALE  
BEACH

NEPEAN HWY

AZURA  
*Aspendale*



# All things Aspendale

A prized pocket affording a tranquil coastal lifestyle, Aspendale is perfectly balanced with cosmopolitan amenities and beach town charm. Safe, established and liveable, Aspendale is well known for its exceptional environment and easy going way of life.

## FOOD & DRINKS

- 1 Bang Bang
- 2 Doyles Bridge Hotel
- 3 Hendriks Café
- 4 Le Feu
- 5 Morris Leigh Café
- 6 Soul Press
- 7 Sunny Boy Beach Club
- 8 Two Farm Girls

## HEALTH

- 9 Seaside Spa Retreat
- 10 Step Into Life Aspendale
- 11 The Pilates Vibe

## EDUCATION

- 12 Aspendale Primary
- 13 Cornish College
- 14 St Louis de Montfort's School

## PARKS & RECREATION

- 15 Aspendale Beach
- 16 Aspendale Gardens
- 17 Aspendale Tennis Club
- 18 Edithvale Wetlands
- 19 Mordialloc Creek
- 20 Mordialloc Pier
- 21 Mordialloc Sailing Club
- 22 Rosedale Golf Course

AZURA  
*Aspendale*

15 MINUTES TO  
SANDRINGHAM

30 MINUTES TO  
MELBOURNE CBD

Braeside

Waterways

10 MINUTES TO  
EASTLINK

20 MINUTES TO  
MORNINGTON  
PENINSULA

EDITHVALE RD

Edithvale

WELLS RD

MORNINGTON PENINSULA Fwy

SPRINGVALE RD

GOVERNOR RD

NEPEAN HWY

STATION ST



*The best of beachside living*



Aspendale Beach

BEACHSIDE LIVING

Vast stretches of stunning crystal blue water lined with colourful beach boxes define the Aspendale coastline. A relaxed and luxurious Bayside lifestyle is inherent in this sophisticated destination, renowned for its idyllic coastline and regarded as one of the best beaches in Melbourne. This highly sought locale is guaranteed to offer the best of beachside living.

ASPENDALE BEACH

Aspendale Beach is widely regarded as one of the safest swimming beaches in Melbourne, with calm and tranquil shallow waters that sparkle in the sunshine. This 7.5 km long beach that stretches between the Patterson River mouth and the Mordialloc breakwater boasts calm conditions perfect for a morning swim or a late afternoon paddle.



Aspendale Beach Boxes



Aspendale Beach



RECREATION

Bayside boasts a multitude of opportunities to enjoy the beachside surrounds, whether it's a morning bike ride along Beach Road soaking up the picturesque view or a brisk stroll along the water's edge. Rossdale Golf Course is also a prominent local staple and renowned for its inclusive and friendly club culture, showcasing a picturesque course weaving through corridors of pines and eucalyptus trees.

PARK LIFE

Offering a multitude of parklands and reserves, Aspendale is renowned for cultivating an outstanding outdoor lifestyle, leveraging its location and neighbouring suburbs. Significant wetland areas also prove popular for walkers and joggers, with one of Port Phillip's largest natural wetland, Edithvale Wetlands, showcasing walking tracks or bike paths along waterways and through lush parklands.

RETAIL & HOSPITALITY

Restaurants and cafés are in abundance, both in and around Aspendale. Sunday's are perfect for brunch and Morris Leigh Cafe serves up a delicious spread of breakfast favourites. Or enjoy a morning coffee after a walk with friends at another Aspendale hot spot, Two Farm Girls. Relish the culinary delights of Hendriks Cafe in Mordialloc, with a glass of red and a fresh salad from their delightful all-day menu.

AMENITY

Easily accessible, shops and public transport are only a short walk or drive from your doorstep. Aspendale Train Station is perfectly positioned at the top end of Foster Street and connects locals to Melbourne's CBD and other neighbouring suburbs, as well as Southland Shopping Centre. Whilst the local bus allows for an easy commute along Station Street to additional local amenities.



Beach Road



Edithvale Wetlands



Two Farm Girls



Aspendale Train Station



PARTNERS & SUPPLIERS

*A collaboration between  
a team of experts*

DEVELOPER & BUILDER

Lowe Group is a market-leading property development and construction company, specialising in the creation of high-quality apartments, townhomes and homes in Melbourne’s most aspirational suburbs. Reflecting core design principles of quality, style and enjoyable living, Lowe Group, together with its two divisions Lowe Living and Lowe Create, strive to set new standards for home design.



Another quality project by  
**LOWE** | LIVING

Lowe Living deliver stunning homes with an engendered culture of trust and respect amongst partners and clients. They are responsible for the end-to-end development of luxury residential apartments and townhomes. As one of two divisions within Lowe Group, Lowe Living’s services include site acquisition, development management, sales and marketing support, as well as architectural advisory and ongoing optimisation during build.



Proudly built by  
**LOWE** | CREATE

Alongside Lowe Living is Lowe Create, the design and construction partner. Lowe Create provides building services to Lowe Living, as well as discerning individuals and is respected for its expert design and meticulous construction services. To date, Lowe Create has developed a strong reputation for building premium homes of enduring quality, forging a presence across Melbourne and in particular the Bayside area.

Mordialloc Pier



DESIGN PARTNERS

An astounding vision brought to life in collaboration with an esteemed team of professionals, Azura brings together Chamberlain Architects, interior architects, Golden and landscape architect, Jack Merlo, to deliver a sophisticated enclave of residences for the discerning buyer.



CHAMBERLAIN  
ARCHITECTS

Chamberlain Architects is a residential specialist studio with extensive experience in crafting high-quality, liveable residences. Chamberlain Architects takes pride in creating homes with a distinct personality, built around their clients’ lifestyle. They combine creativity and attention to detail with a sound understanding of the complexities of planning and property development to deliver outstanding projects for their clients.



GOLDEN

The best design decisions express the absolute with an understated knowing. Golden is pedantic about material quality and revere customisation. Their practice is to cultivate brilliance from the innermost details, then radiate those elements back out. Golden projects have a resonance that is designed to be experienced, not just photographed. The effect is exclusive, but not branded; unspoken and deeply felt.

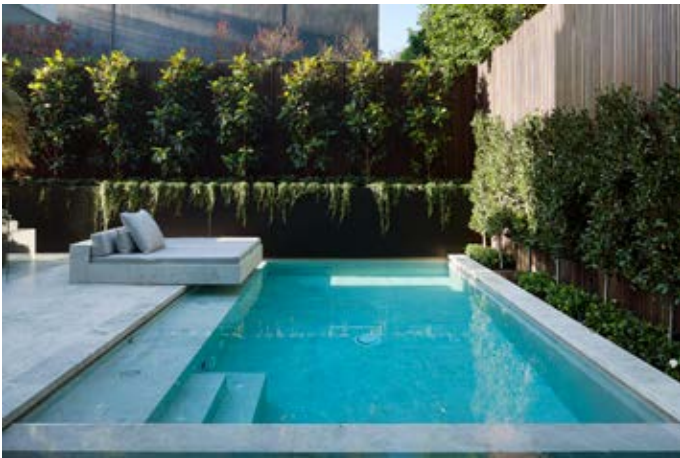

JACK  
MERLO

Jack Merlo is one of Australia’s premier landscape architecture studios, lead by Jack Merlo himself. Bringing a unique architectural approach to landscape design, he focuses on creating spaces that people will appreciate for years to come. Working closely with leading architects and developers, each new project is an individual and considered response, providing an ordered and organic form to the built environment.

PREMIUM SUPPLIERS

Proudly partnering with quality suppliers such as Miele, Phoenix Tapware and Lumil, Lowe Living ensure all aspects of their projects revolve around the client and their future lifestyle.



Miele is Lowe Living’s preferred appliance supplier. Fitted throughout Azura and all Lowe Living projects, Miele offers products that set the standards for durability, performance, ease of use, energy efficiency, design and service. For Miele, sustainability is entrenched in the values and traditions of the company and is the absolute foundation for their long-standing reputation.



Azura features tapware fixtures exclusively from Phoenix Tapware. Founded on the principles of design, quality and customer service, Phoenix has been producing tapware, showers and accessories since 1989. Their in-house design team’s expertise in style, innovation and first-class engineering, have established their prominent position in the Australian bathroom and kitchen industry.



lumil

Azura’s kitchen design features a bespoke Lumil feature pendant throughout ‘*The Beachfront Collection*’ and an available upgrade to all Azura residences. Founded with a vision to create locally made feature lights through a process of material exploration, local collaboration and curiosity, their designs look to redefine how lighting can be represented in modern environments.



Whilst all care has been taken in the preparation of this brochure, no warranty is given as to the accuracy, currency or completeness of the information contained within it and it is not intended to be relied upon in any way by any party including any prospective purchaser. This document is not an offer to purchase or a contract. This brochure, and the information contained within it, is for presentation purposes only and is subject to change without notice and is subject to obtaining all planning and development approvals. Illustrations, images, plans, statements, figures, dimensions, views, calculations and representations contained in this brochure are depictions, impressions or estimates and are intended as a guide only and are subject to change. All area calculations are based on the Property Council of Australia method of measurement guidelines and are estimates only. Any dimensions or areas may differ from surveyed areas due to different methods of measurement. External areas include planter and tiled areas (where applicable). All loose furniture, loose planter boxes, white goods (excluding refrigerators) and other items depicted are not included in the sale of any apartment and are for illustrative purposes only. Study desks, television console units, kitchen pendants, bar units and fireplaces are an upgrade option. Foster Street Developments Pty Ltd ACN 625 053 812, 1A Foster Street Aspendale Pty Ltd ACN 623 136 774, John Norman Imbesi and Lowe Group Holdings ACN 625 052 431 and their related companies, consultants and agents accept no responsibility for any of the information contained in this brochure or for any act or omission taken in reliance upon it by any party and prospective purchasers must make their own enquiries.

*"Co-existing with Aspendale's cobalt waters,  
Azura redefines coastal living"*

TIM LOWE, MANAGING DIRECTOR, LOWE GROUP



[AZURAASPENDALE.COM.AU](http://AZURAASPENDALE.COM.AU)

**LOWE** | LIVING

[lowegroup.com.au](http://lowegroup.com.au)